



## Position Coupler

The RC series is designed to quickly join two curved, bent or straight bars, when neither bar can be rotated and where the ongoing bar is restricted in its axial direction. Typical applications for these couplers are for splicing of prefabricated cages.



## Features and Benefits

- Can be used in a wide variety of global rebar grades and deformation patterns
- Meets or exceeds international building codes including ACI 318 Type 1 & Type 2, BS8100, DIN1045 , Hong Kong Building Department Type 2
- Rebar does not need to be rotated - designed to join two curved, bent or straight bars where neither can rotate.
- Installs quickly with taper threads
- Lock nut provided to eliminate slip of the parallel thread.
- Slim design frees up space in congested areas



## Typical Applications

- Prefabricated Cages
- Bent bars splicing.

Part Number	US Rebar Size	Metric Rebar Size	Canada Rebar Size	L1 (in)	L1 (mm)	D1 (in)	D1 (mm)	BD1 (in)	BD1 (mm)	BG1 (in)	BG1 (mm)	Max Ext (in)	Max Ext (mm)	Weight (lbs)	Weight (kg)
RC20	#6	20	20M	3.62	92	1.77	45	1.28	33	1.57	40	.95	24	2.42	1.1
RC25	#8	25	25M	4.13	105	2.16	55	1.50	38	2.00	51	.95	24	3.97	1.8
RC32	#10	32	-	5.43	125	2.56	65	1.87	48	1.69	43	.95	24	4.63	2.1
RC40	-	40	-	5.47	139	3.14	80	2.36	60	1.57	40	.95	24	5.95	2.7
RC50	-	50	-	6.33	161	3.74	95	2.58	66	1.96	50	1.14	29	11.9	5.4

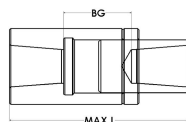

DIMENSIONS ARE FOR REFERENCE ONLY.

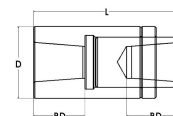

DIMENSIONS ARE FOR REFERENCE ONLY.